

This drawing has been based on survey information supplied by an independent surveying company. Whilst the information provided is believed to be accurate, IMA Transport Planning Ltd shall not be liable for any inaccuracies or deficiencies arising from it.

**Notes:**

1. Traffic lights to be under automatic control, except for the hours of 07:30 - 10:00 and 16:00 - 18:00, when manual control is to be used
2. All footways unaffected by the works (i.e. outside of the works area) to remain open unless otherwise agreed with University of Bath.

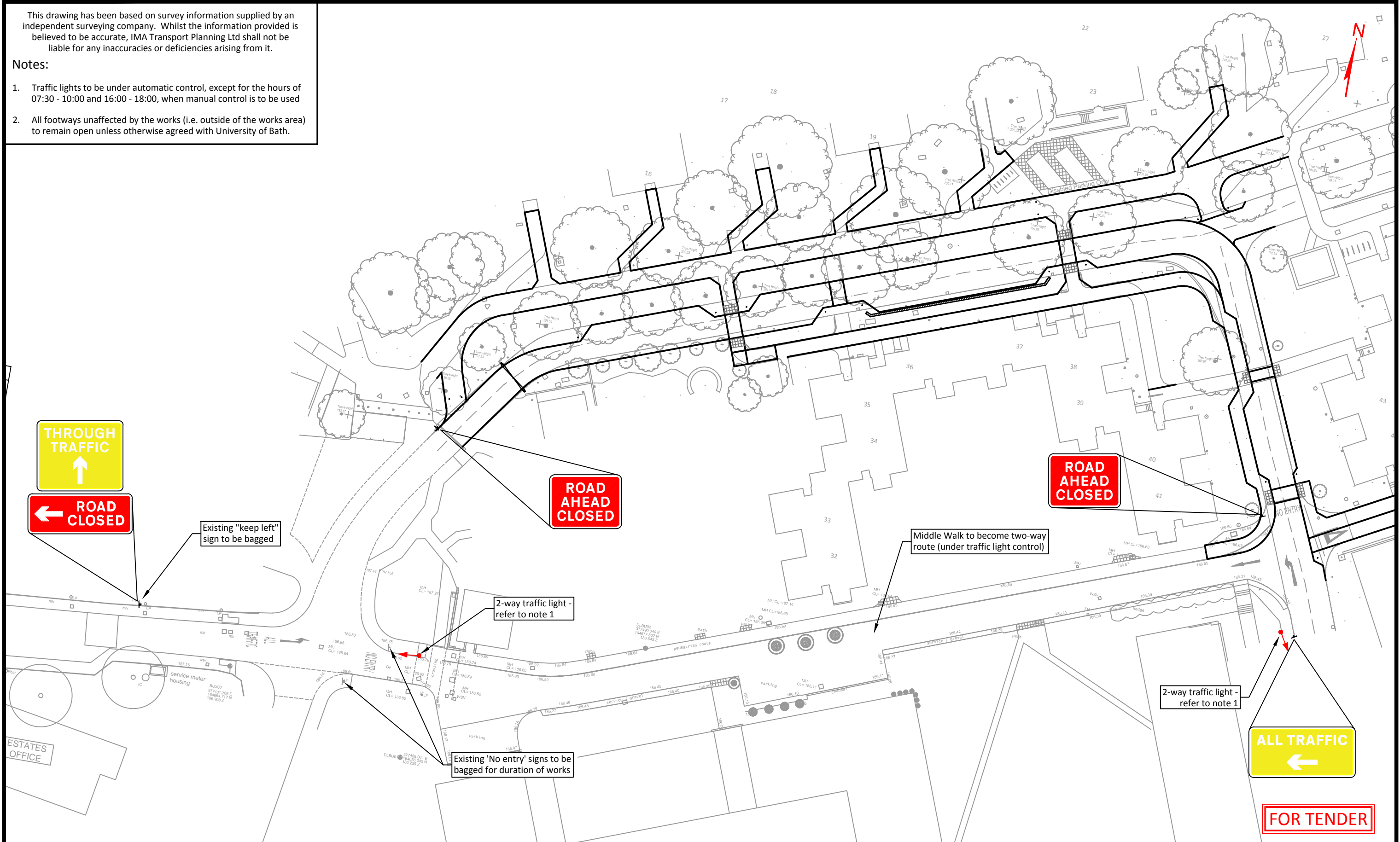

**IMA** TRANSPORT PLANNING  
 11 KINGSMEAD SQUARE  
 BATH BA1 2AB  
 t: 01225 444 011  
 f: 01225 444 055  
 www.ima-tp.com

CLIENT: University of Bath  
 PROJECT: External Works Enhancements Upper Walk

TITLE: Traffic Management Plan

SCALE: (A3) 1:500	CHECKED: SW	APPROVED: DS
CAD FILE: IMA-15-166_051.dwg	DESIGN/DRAWN: OH	DATE: April 2016
PROJECT No: IMA-15-166	DRAWING No: 051	REV: T1